

# Mounting Instruction bSWM

## INTRODUCTION

MTXLEDs bSWM lamp can be mounted in three different ways:

1. SUPPORT MOUNTING – THICK PLATE
2. SUPPORT MOUNTING – THIN PLATE
3. BACK MOUNTING

Mounting kit MK7 is added to each lamp.

## USEFUL TOOLS

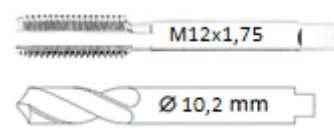
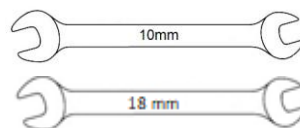

## 1. SUPPORT MOUNTING – THICK PLATE

For this mounting system SWM-MK7 Mounting kit is required.

This mounting system is recommended for metal plates at least 8mm thick.

In this method threading is required.

Bolts tighten with moment 49 Nm.

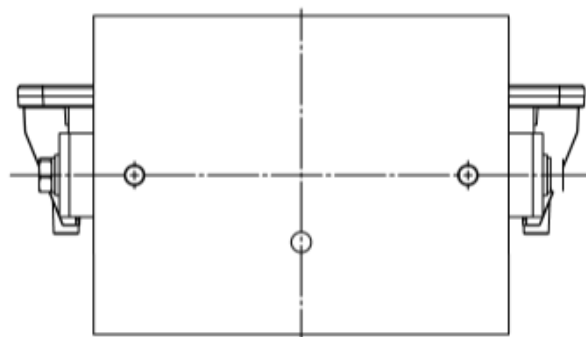
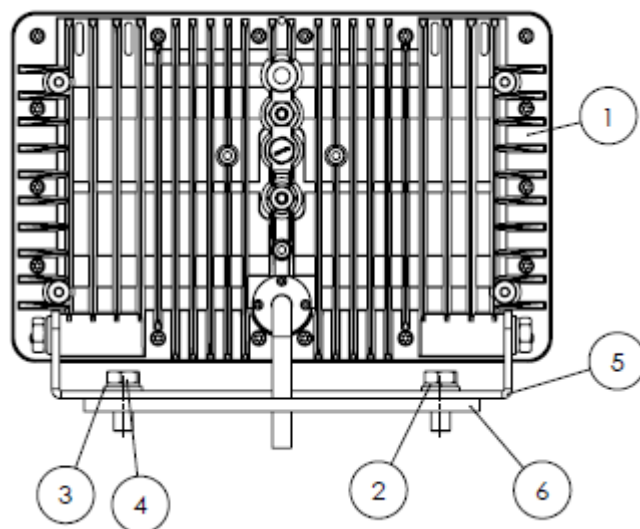
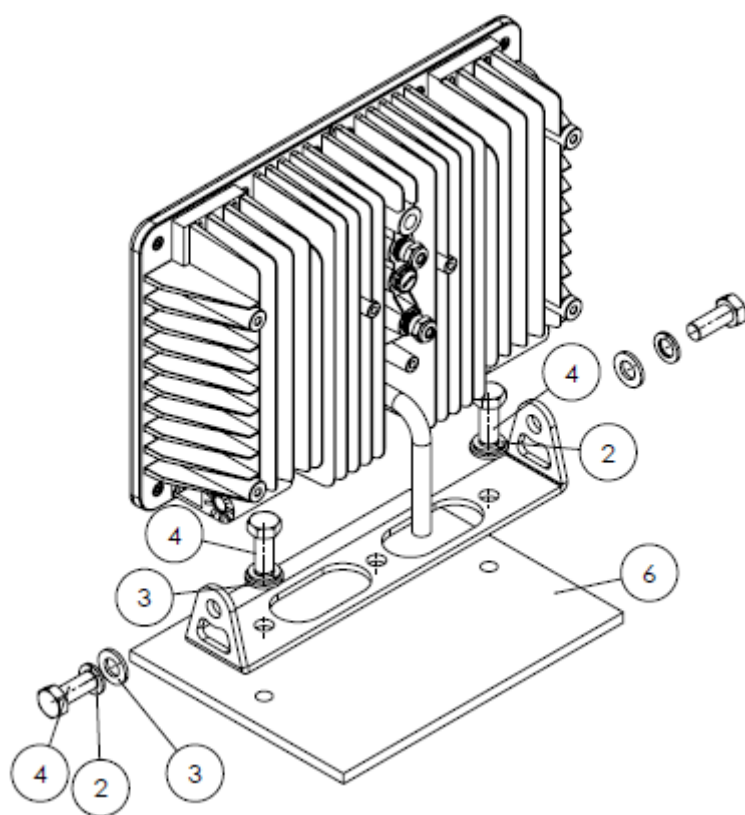

NO.	Description	QTY.
1	Lamp	1
2	M12 Spring washer	5
3	M12 Washer	8
4	M12x30 Bolt	4
5	Support Plate (big)	1
6	Mounting surface	-

### Contact:



+40 748 751 465

[sales@mtxledsolutions.com](mailto:sales@mtxledsolutions.com)

[www.mtxledsolutions.com](http://www.mtxledsolutions.com)

MTX LED reserves the right to make technical changes without prior notice.

Copyright © MTX LED 21.06.2018 VA 01

# Mounting Instruction bSWM

## 2. SUPPORT MOUNTING – THIN PLATE

For this mounting system SWM-MK7 Mounting kit is required.

This mounting system is recommended for metal plates thinner than 5mm.

Bolts tighten with moment 49 Nm.

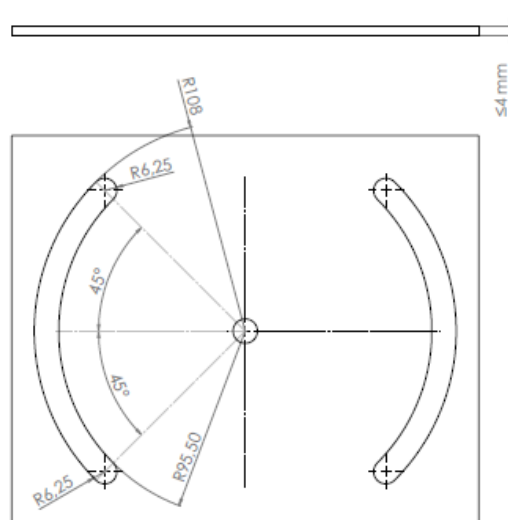
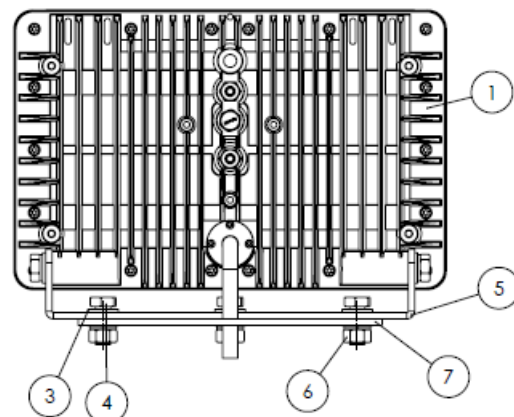
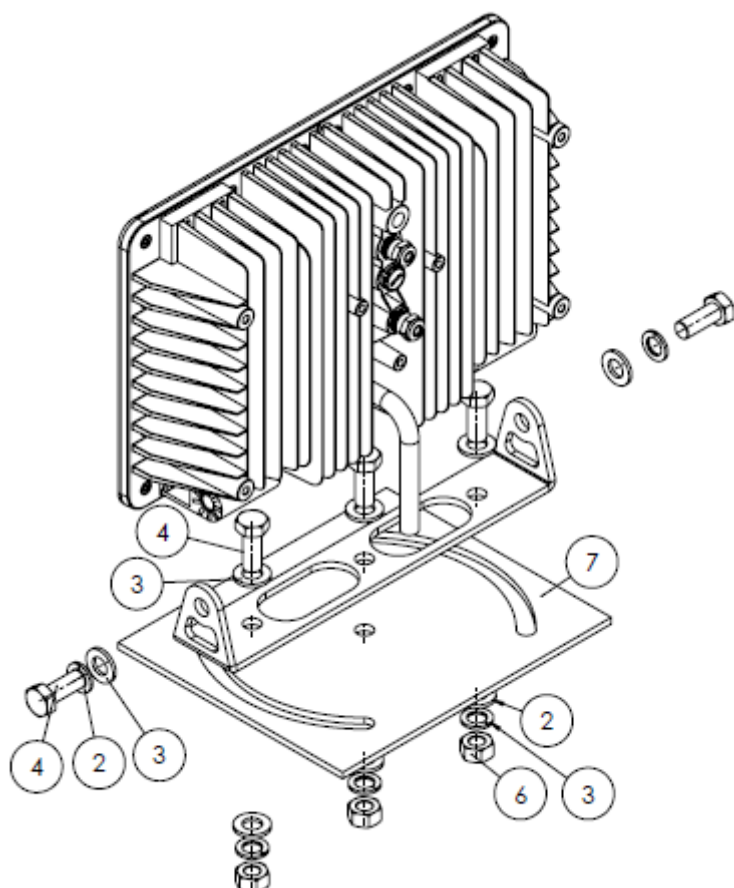

NO.	Description	QTY.
1	Lamp	1
2	M12 Spring washer	5
3	M12 Washer	8
4	M12x30 Bolt	5
5	M12 Nut	3
6	Support Plate	1
7	Mounting surface	-

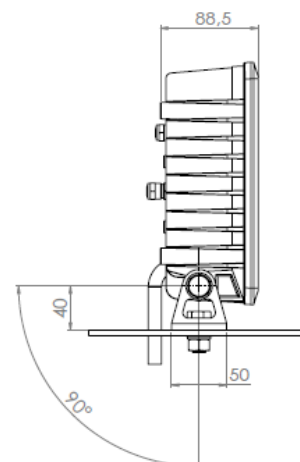
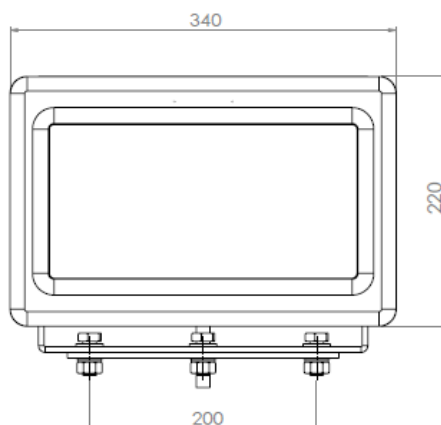

### Contact:



+40 748 751 465

[sales@mtxledsolutions.com](mailto:sales@mtxledsolutions.com)

[www.mtxledsolutions.com](http://www.mtxledsolutions.com)

MTX LED reserves the right to make technical changes without prior notice.

Copyright © MTX LED 21.06.2018 VA 01

# Mounting Instruction bSWM

## 3. BACK MOUNTING

For this mounting system SWM-MK8

Mounting kit is required.

This mounting system is recommended for metal plates thinner than 5mm.

Bolts tighten with moment 6,6 Nm.

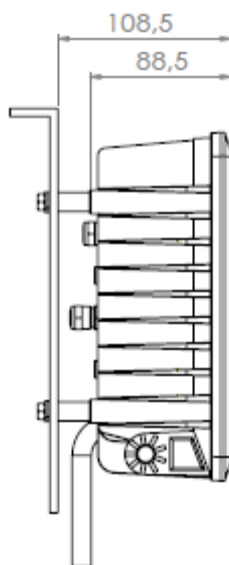
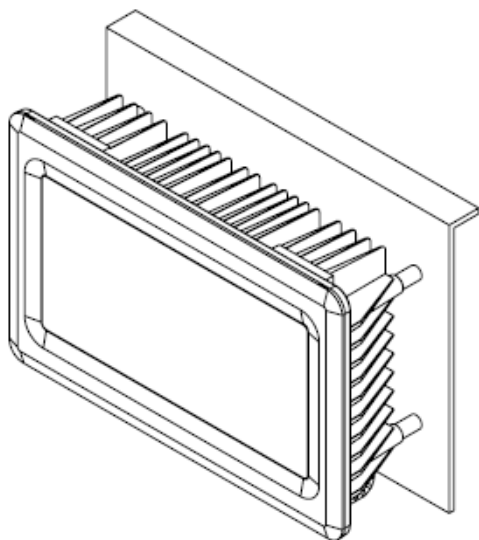
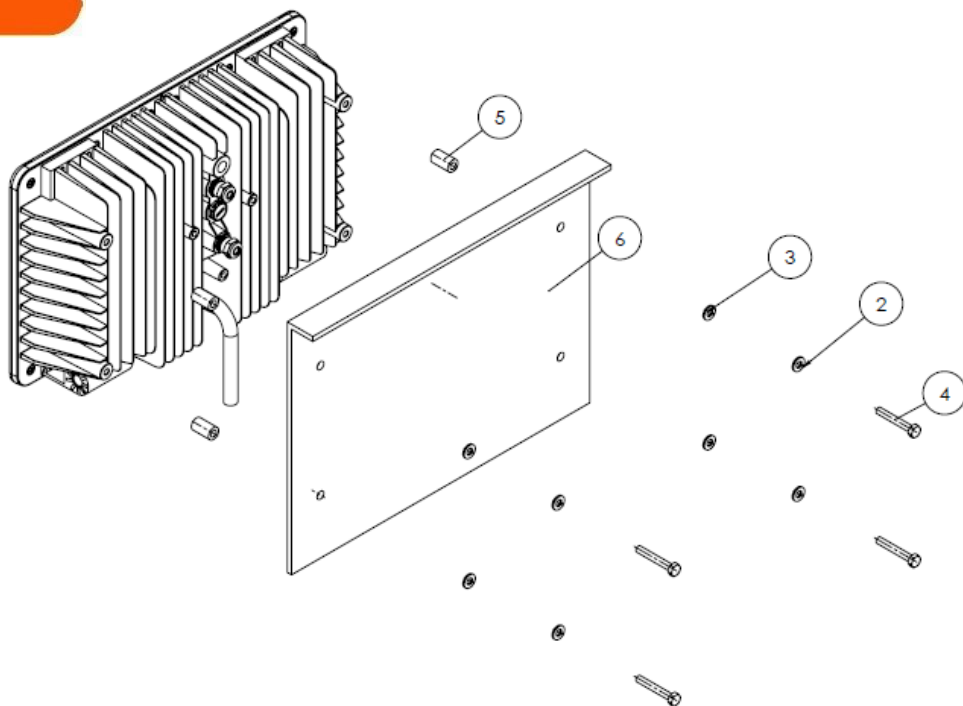

NO.	Description	QTY.
1	Lamp	1
2	M6 Spring washer	4
3	M6 Washer	4
4	M6x50 Bolt	4
5	ø12x20 Distance spacer	4
6	Mounting surface	-

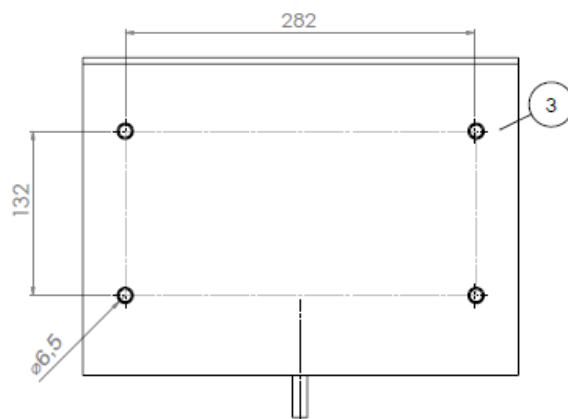

### Contact:



+40 748 751 465

[sales@mtxledsolutions.com](mailto:sales@mtxledsolutions.com)

[www.mtxledsolutions.com](http://www.mtxledsolutions.com)

MTX LED reserves the right to make technical changes without prior notice.

Copyright © MTX LED 21.06.2018 VA 01

# Mounting Instruction bSWM



## 4. ELECTRIC CONNECTION

Each lamp should be protected by proper fuse, according to technical table.

		Narrow light		Wide light	
Supply voltage		10-30 V			
Average power consumption		12 V	24 V	12 V	24 V
		10 A	5 A	10 A	5 A
Max. Impulse current		15 A		15 A	
Recommended fuse value*		20 A		20 A	
Polarity	Brown	+		N/C	
	Yellow-Green	N/C		+	
	Blue	-			

\*Recommended is use two fuses separately for narrow light and wide light

### Contact:



+40 748 751 465

[sales@mtxledsolutions.com](mailto:sales@mtxledsolutions.com)

[www.mtxledsolutions.com](http://www.mtxledsolutions.com)

MTX LED reserves the right to make technical changes without prior notice.

Copyright © MTX LED 21.06.2018 VA 01