

Mounting instruction SWL

INTRODUCTION

SWL can be mounted in two ways

1. MOUNTING WITHOUT FRAME
2. MOUNTING WITH FRAME

USEFULL TOOLS



1.MOUNTING WITHOUT FRAME

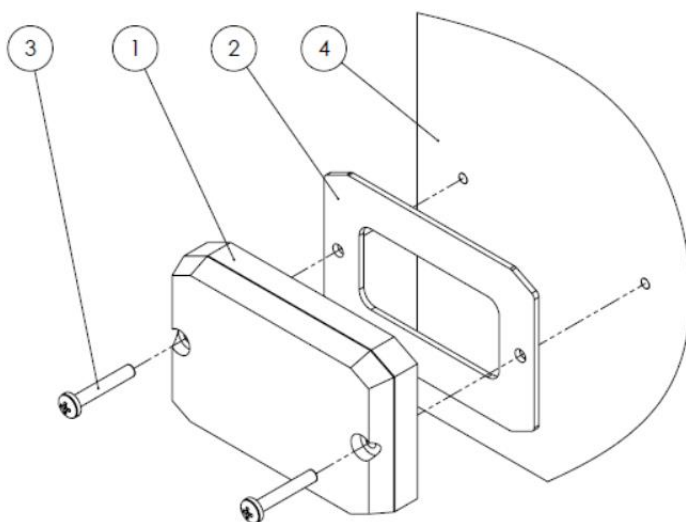

NO	Description	QTY
1	Lamp	1
2	Pad	1
3	St.4.2x25 Screw	2
4	Mounting surface	-

2. MOUNTING WITH FRAME

NO	Description	QTY
1	Lamp	1
2	Pad	1
3	Frame	1
4	St.4.2x25 Screw	2
5	Mounting surface	-

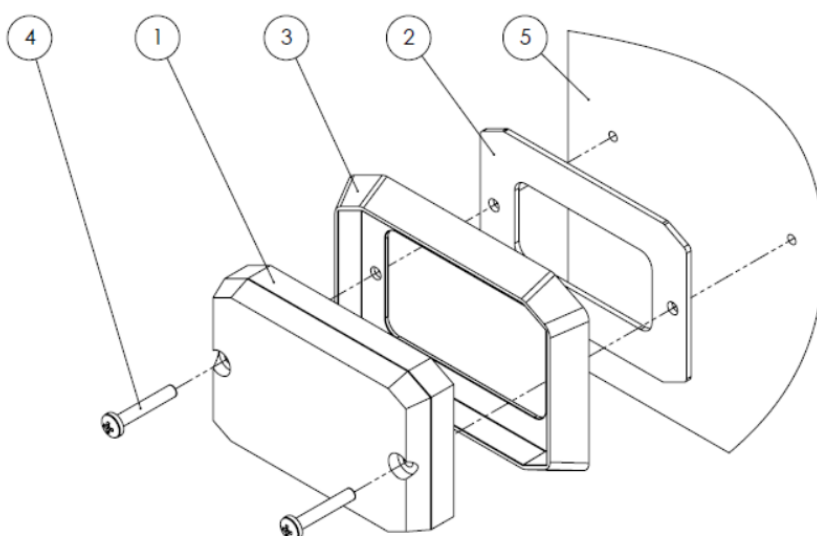

Contact:



+40 748 751 465

sales@mtxledsolutions.com

www.mtxledsolutions.com

MTX LED reserves the right to make technical changes without prior notice.

Copyright © MTX LED 13.08.2019 R02

Mounting instruction SWL

3. ELECTRICAL MOUNTING

Parameter:

Supply voltage	10,5-30VDC	
Average Current	12 V	24 V
	0,5 A	0,3 A
Inrush Current	1 A	0,6 A
Recommended fuse value (single lamp)	2 A	
Wires	Red	VCC
	Black	GND
	Yellow	FP&S Flash Patterns & Sync.
	White	Low Power

Schematic:

Fuse:

Value of fuse depends of number of connected lamps (recommended value):

- 1 x SWL - ~2 A fuse
- 2 – 4 x SWL - ~5 A fuse
- 5 – 8 x SWL - ~10 A fuse
- 9 – 10 x SWL - ~15 A fuse

Flash Patterns:

No.	Flash Patterns
1	Single
2	Double
3	Triple
4	Quad

Switch Pattern:

FP&S (YELLOW) wires connect to VCC (RED) wires

- Once for next Flash Pattern.
- Quickly three times for RESET to Flash Pattern No.1.

Synchronize lamps:

Connect FP&S (YELLOW) wires of all together for synchronization, (All lamps should be set at the same Flash Pattern)

- Possible works with other model of MTX lamps.

Alternating or Simultaneous Flash (change Group):

1. Apply plus of power to VCC (RED) and FP&S (YELLOW) wires simultaneously to enter grouping mode; lamps will display short (single or double) flashes:
 - Single flash = Group 1
 - Double flash = Group 2
2. Disconnect FP&S (YELLOW) wire from VCC and momentarily apply to VCC to change Groups:
 - Lamps in the same Group flash together.
 - Group 1 lamps flash alternate with Group 2 lamps.

Low Power mode (day/night):

Connect the Low Power (WHITE) wires to VCC to enable Low Power (night) mode. The lamp will return to full brightness when the Low Power (WHITE) wire is disconnected.

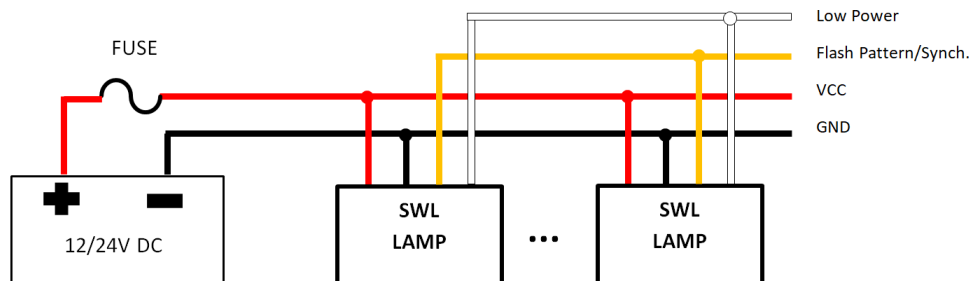

Contact:



+40 748 751 465

sales@mtxledsolutions.com

www.mtxledsolutions.com

MTX LED reserves the right to make technical changes without prior notice.

Copyright © MTX LED 13.08.2019 R02